

ST044RS

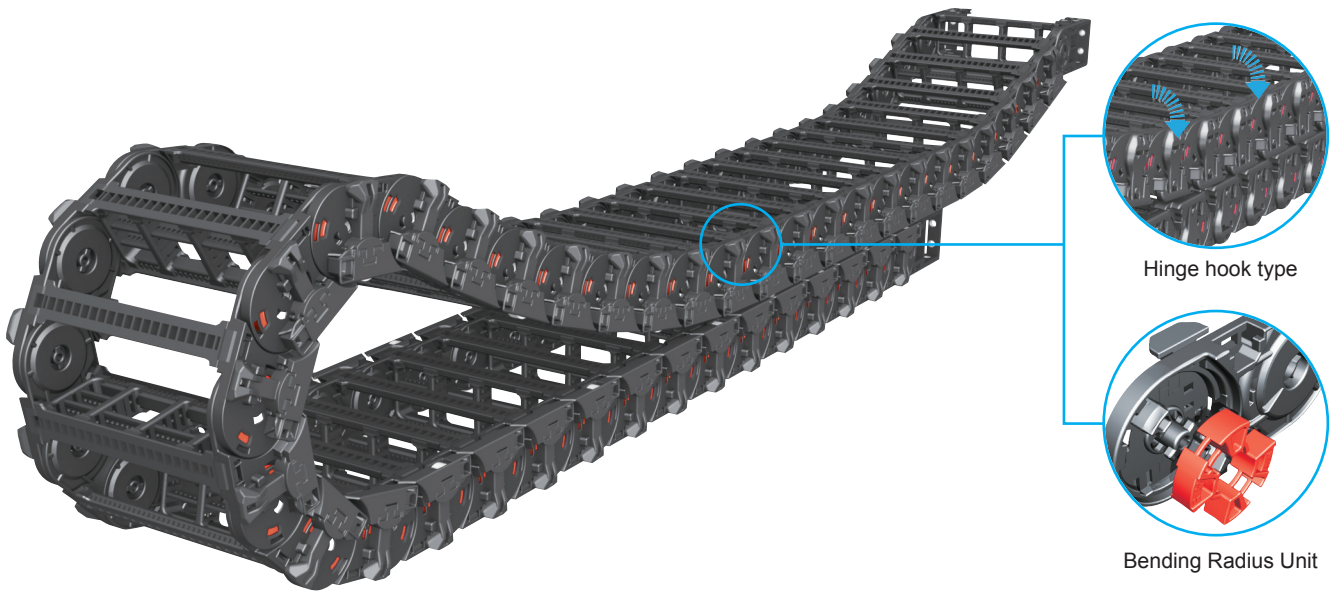

Layout of the Chain

Ls: Stroke

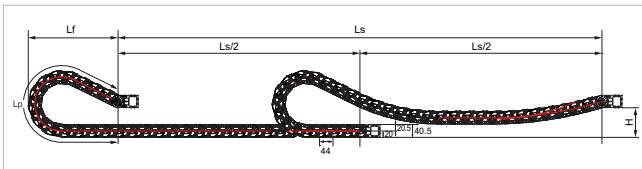

Bending Radius(R)	Lp Loop Length	Lf Loof Projection	H Moving Height
70	544	249	110
90	662	289	
120	926	393	
150	1,190	497	

Chain Cross Section

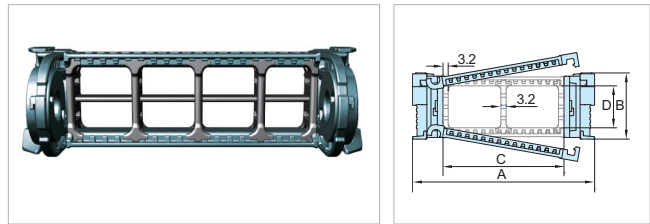

Chain Type	A Width(Outer)	B Height(Outer)	C Frame Width(Inner)	D Height(Inner)	Weight kg/m
ST044RS	73	40.5	35	26	1.09
	88		50		1.15
	93		55		1.17
	113		75		1.24
	138		100		1.33
	163		125		1.47
	188		150		1.59
	213		175		1.88
	238		200		2.05

Dividers(DV)

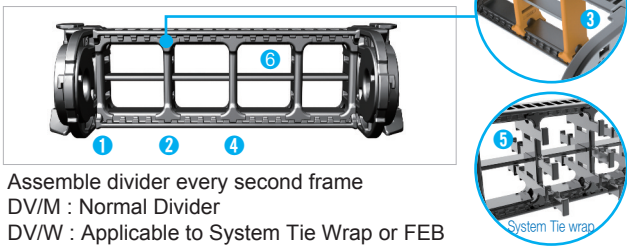

Assemble divider every second frame
 DV/M : Normal Divider
 DV/W : Applicable to System Tie Wrap or FEB

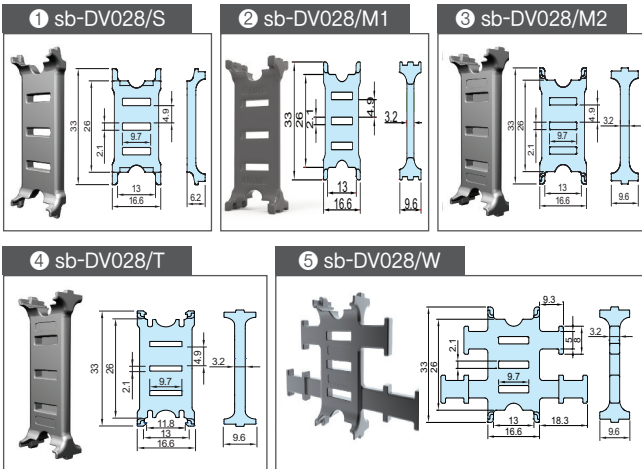

Separators(SP)

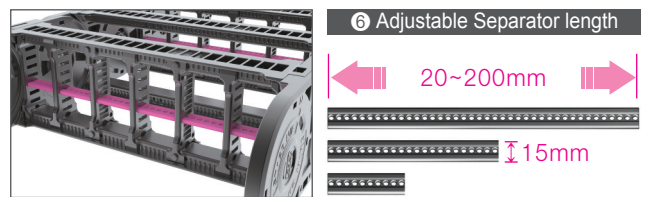

Chain Type	Ordering No.	Frame
ST044RS	S-SP/M,35	35
	S-SP/M,50	50
	S-SP/M,55	55
	S-SP/M,75	75
	S-SP/M,100	100
	S-SP/M,125	125
	S-SP/M,150	150
	S-SP/M,175	175
	S-SP/M,200	200

Free End Bracket(FEB)

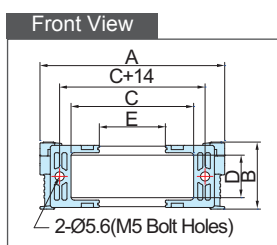
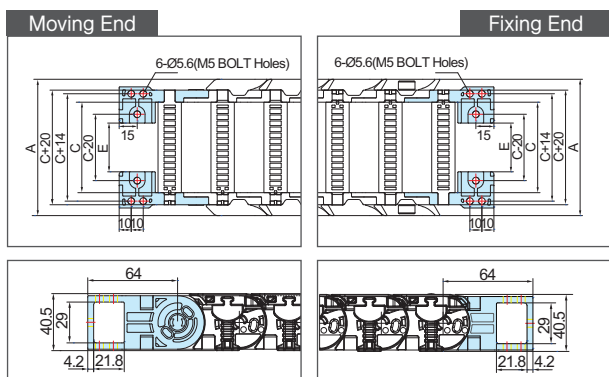

Chain Type	A Width(Outer)	B Height(Outer)	C Frame/Width(Inner)	D Height(Inner)	E M.EB Bolt Holes Width	Hole Type
ST044RS	73	40.5	35	26	0.4	M5 Bolt Holes
	88		50		15.4	
	93		55		20.4	
	113		75		40.4	
	138		100		65.4	
	163		125		90.4	
	188		150		115.4	
	213		175		140.4	
238	200	165.4				

End Bracket(EB)

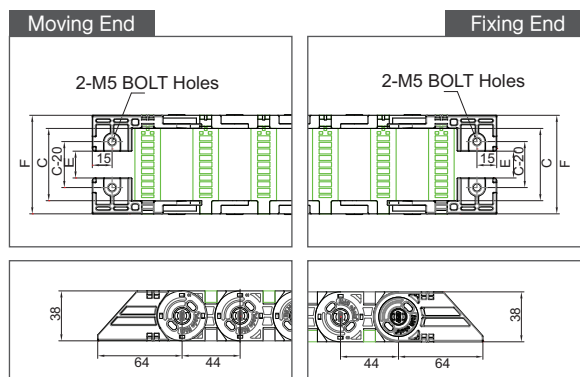

System Tie Wrap(STW)

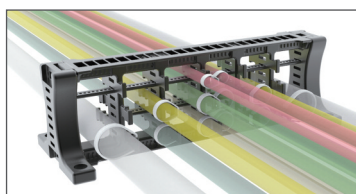

It is a unit to classify each cable for preventing entanglement of cables. It can either be installed to free end bracket or installed separately according its application environment.

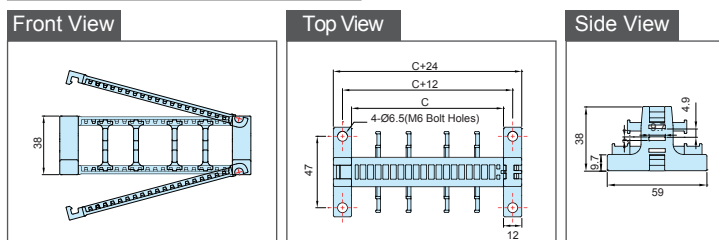

Chain Type	Ordering No.	C Frame	Hole Type
ST044RS	S-TW,EB028,35	35	M6 Bolt Holes
	S-TW,EB028,50	50	
	S-TW,EB028,55	55	
	S-TW,EB028,75	75	
	S-TW,EB028,100	100	
	S-TW,EB028,125	125	
	S-TW,EB028,150	150	
	S-TW,EB028,175	175	
S-TW,EB028,200	200		

Tie Wrap(TW)

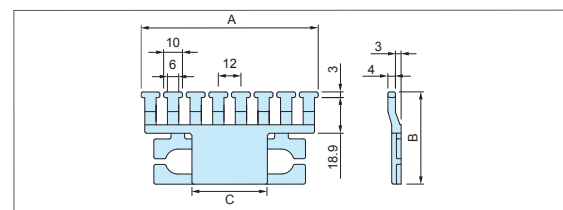
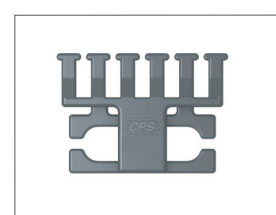
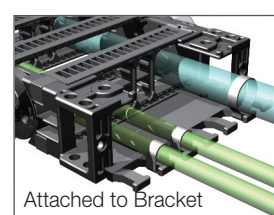

Chain Type	Ordering No.	A	B	C
ST044RS	S-TW036/025CR,35	46	35.4	-
	S-TW036/025CR,50	69	48.9	15
	S-TW036/025CR,55	70	48.9	20
	S-TW036/025CR,75	94	48.9	40
	S-TW036/025CR,100	118	48.9	65
	S-TW036/025CR,125	142	48.9	90

Guide Channel

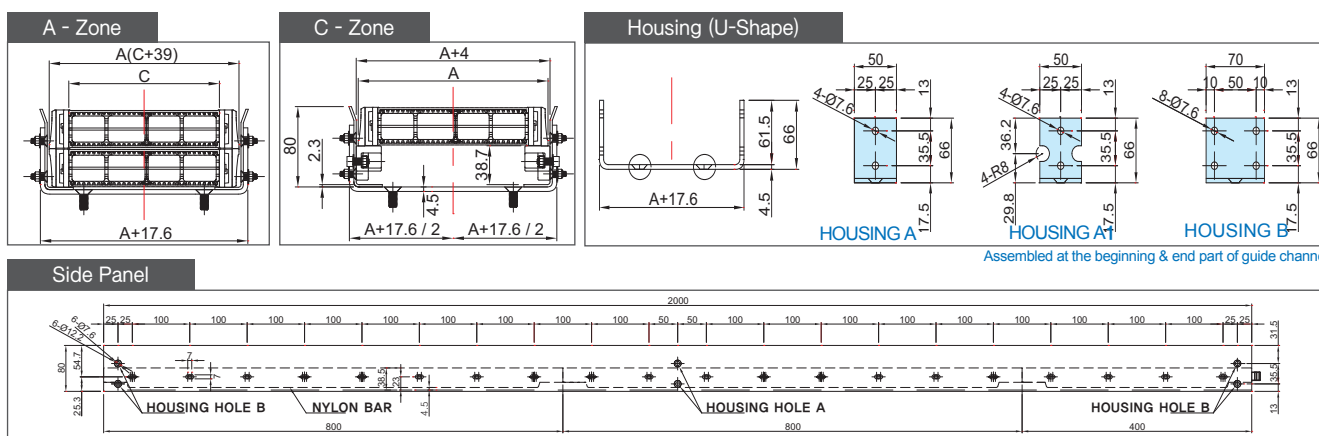

※ Dimensions in mm